

PROPOSED FOUNDRY MAN WORKSHOP CONSTRUCTED  
ON C.S PLOT NO - KHATIAN NO-  
AT MIDNAPUR ITI , DIST-MIDNAPUR.  
PLINTH AREA- 196.475 SQ.M.

SIGNATURE OF ENGG

ALL DIMENSIONS ARE IN M.M.

SIGNATURE OF OWNER

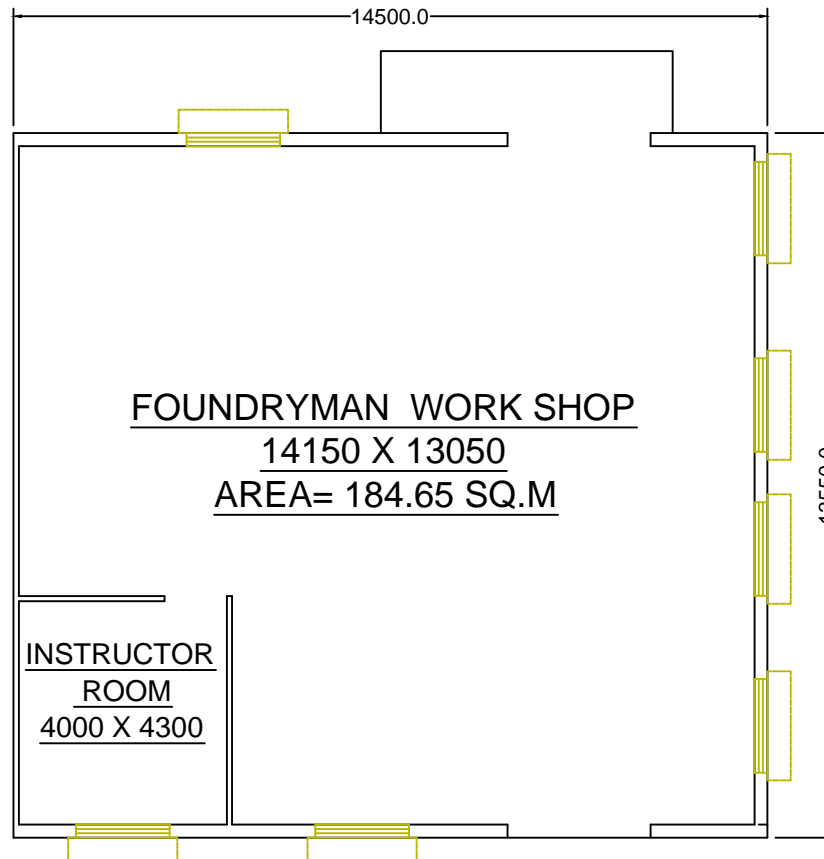

GR FLOOR PLAN (SCALE-1:100)